



# TECAPRES®

Ø150mm · G1/8 connectable  
18300daN

## TPF 18300 C

VDI SAFETY



PED  
2014/68/EU

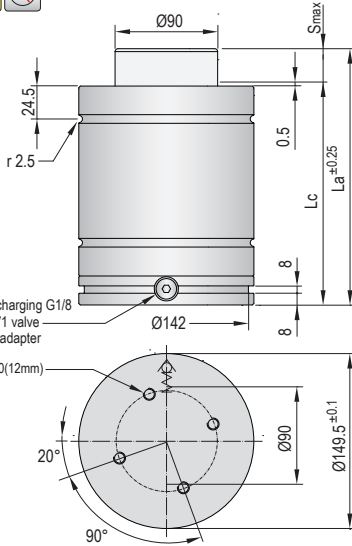

Gas charging G1/8  
TPFV1 valve  
G1/8 adapter



Under request

- Pressure medium **Nitrogen (N<sub>2</sub>)**
- Max. charging pressure **150 Bar**
- Min. charging pressure **50 Bar**
- Piston seal area **122,72 cm<sup>2</sup>**
- Operating temperature **0°C - 80°C**
- Force increase by temperature **0,33 %/°C**
- Max. stem speed **25 m/min**
- Maintenance kit **Kit F18300C**



Maximum strokes / minute (at 20°C)

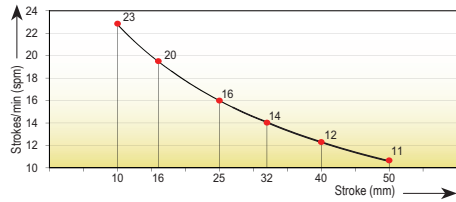

Code	Smax mm	La mm	Lc mm	Fa daN	85% F daN	100% Fc daN	P Bar	V l	Kg
TPF 18300x10 C	10	110	100	18300 ±5% (20°C)	22665	23630	150 (20°C)	0,555	9,10
TPF 18300x16 C	16	136	120		23420	24600		0,780	9,95
TPF 18300x25 C	25	165	140		24450	25950		1,055	10,80
TPF 18300x32 C	32	197	165		24250	25690		1,385	13,26
TPF 18300x40 C	40	235	195		24045	25415		1,780	15,10
TPF 18300x50 C	50	270	220		24415	25905		2,120	16,80

**Attention!**  
This model is designed to work in a hose system.

Force/stroke ratio

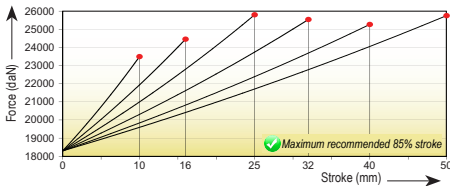

Initial force/charging pressure ratio

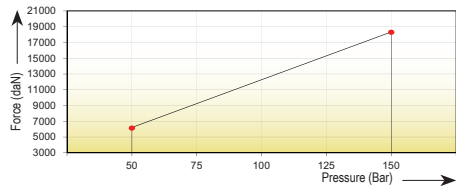

Assembly possibilities

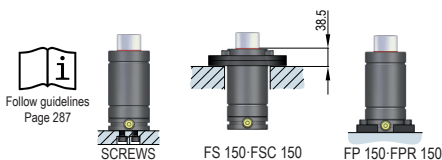

Follow guidelines  
Page 287

Connection alternatives

